

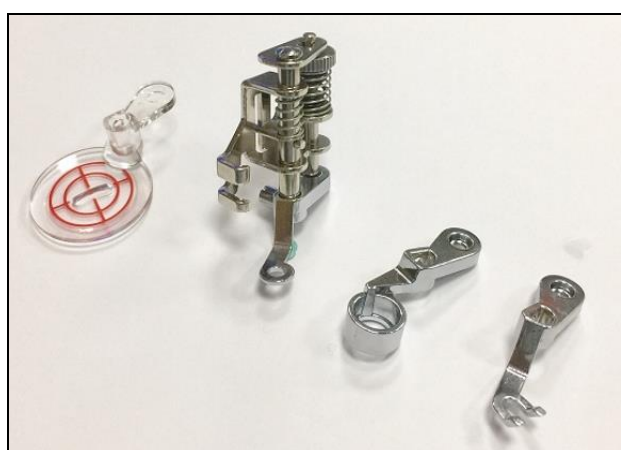

FREE MOTION QUILTING FOOT SET OF TWO, PLUS RULER FOOT AND ECHO FOOT (Precision made in Taiwan) - low shank for Janome, Brother, Baby Lock, Singer, Elna, Toyota, Juki, Pfaff, Husqvarna/Viking etc. etc.

This convertible foot set improves visibility and reduces vibration, providing professional stitches. Each set consists of the followings:

1. Adjustable height foot holder.
2. Closed toe free motion quilting foot.
3. Open toe free motion quilting/stippling foot.
4. Ruler foot 1/4" from needle to the edge.
5. Clear plastic free motion echo quilting foot.

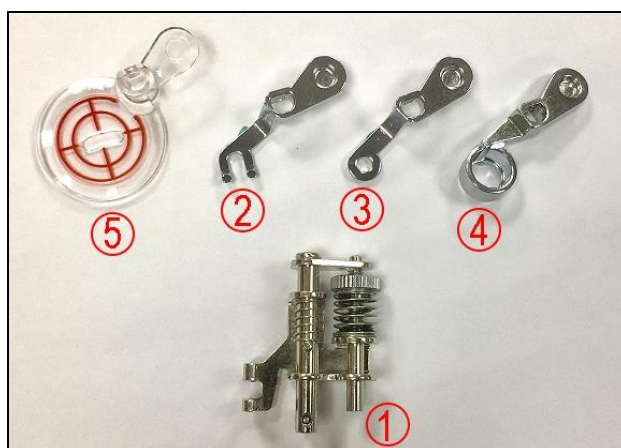

Item No. P92020L

FREE MOTION FOOT SET. LOW SHANK

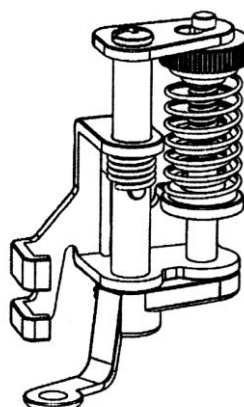

1. CLOSED TOE QUILTING FOOT

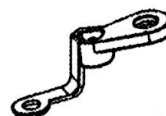

2. ECHO QUILTING FOOT

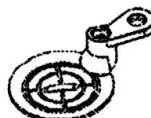

3. OPEN TOE QUILTING STIPPLING FOOT



4. RULER FOOT



1. CLOSED TOE QUILTING FOOT

This foot is for free-motion stitching on the machine and supports fabric when using a straight stitch.

2. ECHO QUILTING FOOT

Give quilting patterns, applique designs and other items a gorgeous frame of echo patterns with this great foot. The built-in clear disk with measured guides helps to create perfect, free-motion "ripping" effects with even spacing and accurate stitching.

3. OPEN TOE QUILTING STIPPLING FOOT

This foot offers excellent visibility while free-motion quilting on your machine.

4. RULER FOOT

Quilt beautiful designs using rulers and acrylic templates with the ruler foot. Needle to the edge 1/4"